

凱譽科技股份有限公司

KAI YUI TECHNOLOGIC CORP.

SPECIFICATIONS 規格書

A) SCOPE 適用範圍 (使用系列產品料號：)

This specification covers " 6.4Ø PHONE JACK & XLR JACK " COMBO 插座

B) CHARACTERISTICS 性能

Standard atmospheric specified, measurements shall be made at temperature , humidity and air pressure within the following limit :

Ambient temperature	:	5 °C	to	35 °C
Relative humidity	:	45 %	to	85 %
Air pressure	:	85 Kpa	to	106 Kpa

標準狀態：沒有特別指定時,測試是在常溫、常濕、常壓下進行：

環境溫度	:	5 °C	to	35 °C
相對濕度	:	45 %	to	85 %
大氣壓力	:	85 Kpa	to	106 Kpa
Operating temperature range	:	-30 °C	to	80 °C
操作溫度範圍	:	-30 °C	to	80 °C
Storage temperature range	:	-30 °C	to	80 °C
保存溫度範圍	:	-30 °C	to	80 °C

C) ELECTRICAL CHARACTERISTICS 電氣性能 .

ITEM 項目	TEST CONDITIONS 測試條件	SPECIFICATION 規格
(C1)Rated Voltage 核定電壓		50V
Rated Current 核定電流		7.5A
(C2)Insulation Resistance 絕緣阻抗	A voltage of 500V DC shall be applied to the terminals. After which measurement shall be made. DC 500V 在端子之間用 DC 500V 測試	6.4Ø PHONE JACK
		100M Ω or more ≥ 100M Ω
		XLR JACK
		Initial:>2GΩ After damp heat test:>0.5GΩ

凱譽科技股份有限公司

KAI YUI TECHNOLOGIC CORP.

ITEM 項目	TEST CONDITIONS 測試條件	SPECIFICATION 規格
(C3) Contact Resistance 接觸阻抗	6.4Ø PHONE JACK	6.4Ø PHONE JACK
	<p>Measurement shall be made at 1 K Hz with 100 mA or less (With the test plug as show in item G)</p> <p><1>Initial before any testing a、Pin to contact or (R-RN,T-TN,S-SN) (N.C.). b、Plug shield to socket or (T,R,S,) (N.O.).</p> <p><2>After life test with mating plug a、Pin to contact or (R-RN,T-TN,S-SN) (N.C.). b、Plug shield to socket or (T,R,S,) (N.O.).</p> <p>在 1 K Hz, 100 mA 以下電流做測定(測試用插棒參考第 G 項)</p> <p><1>初始，在做任何測試前 a、端子與分路, (R-RN,T-TN,S-SN) (常閉) b、插棒各極與插座(T,R,S,)間(常開)</p> <p><2>在以對應插棒做壽命試驗後 a、端子與分路, (R-RN,T-TN,S-SN) (常閉) b、插棒各極與插座(T,R,S,)間, (常開)</p>	<p>Initial :</p> <p>a、$\leq 30m\Omega$ b、$\leq 50m\Omega$</p> <p>After life test :</p> <p>a、$\leq 60m\Omega$ b、$\leq 100m\Omega$</p>
	XLR JACK	XLR JACK
	<p>Measurement shall be made at 1 K Hz with 100 mA or less (With the test plug as show in item H)</p> <p><1>Initial before any testing Plug shield to socket</p> <p><2>After life test with mating Plug shield to socket</p> <p>在 1 K Hz, 100 mA 以下電流做測定(測試用插棒參考第 H 項)</p> <p><1>初始，在做任何測試前 插棒插入後與插座間</p> <p><2>在以對應插棒做壽命試驗後 插棒插入後與插座間</p>	<p>Initial :</p> <p>$\leq 30m\Omega$</p> <p>After life test :</p> <p>$\leq 100m\Omega$</p>

凱譽科技股份有限公司

KAI YUI TECHNOLOGIC CORP.

(C4)Dielectric Strength 耐電壓	6.4Ø PHONE JACK	Without distinct Damage 無異常
	Withstand 0.5 mA (Trip current) 500V AC(50 or 60 Hz) between any open terminal for 1 minute. 可承受 0.5 mA (感度電流), AC 500V (50or 60 Hz) . 1 分鐘 , 在任何 open 端 子之間. (Open terminal: Between each terminal which should not make contact , before plug insert to socket R-T,R-S, after plug insert to socket R-RN, T-TN,) (Open 端子: 指相互未接觸的端子,如未 插入plug 時之R-T, R-S, 插入plug後之 R-RN, T-TN,)	
	XLR JACK	
	Withstand 0.5 mA (Trip current) 1500V AC(50 or 60 Hz) between any open terminal for 1 minute. 可承受 0.5 mA (感度電流), AC 1500V (50or 60 Hz) . 1 分鐘 , 在任何 open 端 子之間. (Open terminal: Between each terminal which should not make contact , before plug insert to socket .) (Open 端子: 指相互未接觸的端子,如未 插入plug 時)	

凱譽科技股份有限公司

KAI YUI TECHNOLOGIC CORP.

D) . MECHANICAL CHARACTERISTICS 機械性能

ITEM 項目	TEST CONDITIONS 測試條件	SPECIFICATION 規格
(D1) Insertion force and Withdrawal force 插入力 / 拔出力 (6.4Ø PHONE JACK)	Initial 初始 (With the test plug as show in item G for 6.4Ø PHONE JACK) (測試用插棒規格參考第 G 項 使用在 6.4Ø PHONE JACK)	Insertion force 插入力 0.3kgf ~ 3.0kgf
		Withdrawal force 拔出力 0.3kgf ~ 3.0kgf
	After life test 壽命試驗後 (With the test plug as show in item G for 6.4Ø PHONE JACK) (測試用插棒規格參考第 G 項 使用在 6.4Ø PHONE JACK)	Insertion force 插入力 0.3kgf ~ 3.0kgf
		Withdrawal force 拔出力 0.3kgf ~ 3.0kgf
(D2) Insertion force and Withdrawal force 插入力 / 拔出力 (XLR JACK)	(With the test plug as show in item H for XLR JACK) (測試用插棒規格參考第 H 項 使用在 XLR JACK)	Insertion force 插入力 0.3kgf ~ 4.0kgf
		Withdrawal force 拔出力 0.3kgf ~ 4.0kgf
	(With the test plug as show in item H for XLR JACK) (測試用插棒規格參考第 H 項 使用在 XLR JACK)	Insertion force 插入力 0.3kgf ~ 4.0kgf
		Withdrawal force 拔出力 0.3kgf ~ 4.0kgf
(D3) Terminal strength 端子強度	Terminals must withstand a 500g minimum pull for 10 seconds before movement or break from housing occurs , but deformation of terminal is authorized . 各端子部須測試荷重 500g , 10 秒 , 端子不可有脫落或塑膠本體不可有破裂等情況 , 但端子部彎曲 , 變形可接受 .	

凱譽科技股份有限公司

KAI YUI TECHNOLOGIC CORP.

E) . ENDURANCE CHARACTERISTICS 耐久性能

ITEM 項目	TEST CONDITIONS 測試條件
(E1)Life test 壽命試驗	6.4Ø PHONE JACK
	<p>The life test shall consist of 5,000 cycles of insertion and withdrawal with test plug(Show in item G), at a rate of 20 to 30 cycles per minute under no load . 壽命試驗在無負荷狀態下 20 ~ 30 回 / 1 分鐘的插入及拔出,做 5,000 回,測試用插棒(參考第 G 項) .</p>
	XLR JACK
	<p>The life test shall consist of 1,000 cycles of insertion and withdrawal with test plug(Show in item H), at a rate of 10 to 20 cycles per minute under no load . 壽命試驗在無負荷狀態下 10 ~ 20 回 / 1 分鐘的插入及拔出,做 1,000 回,測試用插棒(參考第 H 項) .</p>
(E2)Soldering test 焊錫試驗	<p>The terminal of JACK tested shall be dipped into soldering flux or equivalent for 5 ~ 10 seconds and then immersed into molten solder Sn at $260 \pm 5^{\circ}\text{C}$ for 3 ± 0.5 seconds , the coverage should more than 95% . 插座端子部 , 浸助焊劑 5 ~ 10 秒 , 再浸 Sn 溶液—溫度 $260 \pm 5^{\circ}\text{C}$. 時間 3 ± 0.5 秒 , 端子部上錫覆蓋面積須達 95% 以上 .</p>
(E3)Soldering heat 上錫耐熱性	<p>The terminal for a printed circuit board . Temperature of solder : $260 \pm 5^{\circ}\text{C}$ Dip time : 5 ± 1 seconds . 端子部與銅箔面上錫溫度與時間 . 溫度: $260 \pm 5^{\circ}\text{C}$ 時間: 5 ± 1 秒 .</p>
(E4) Hand Soldering Temperature 手焊溫度	<p>Temperature of solder : $350 \pm 10^{\circ}\text{C}$ Dip time : 3 ± 0.5 seconds . 溫度: $350 \pm 10^{\circ}\text{C}$ 時間: 3 ± 0.5 秒 .</p>

凱譽科技股份有限公司

KAI YUI TECHNOLOGIC CORP.

F) . DIP 溫度曲線圖

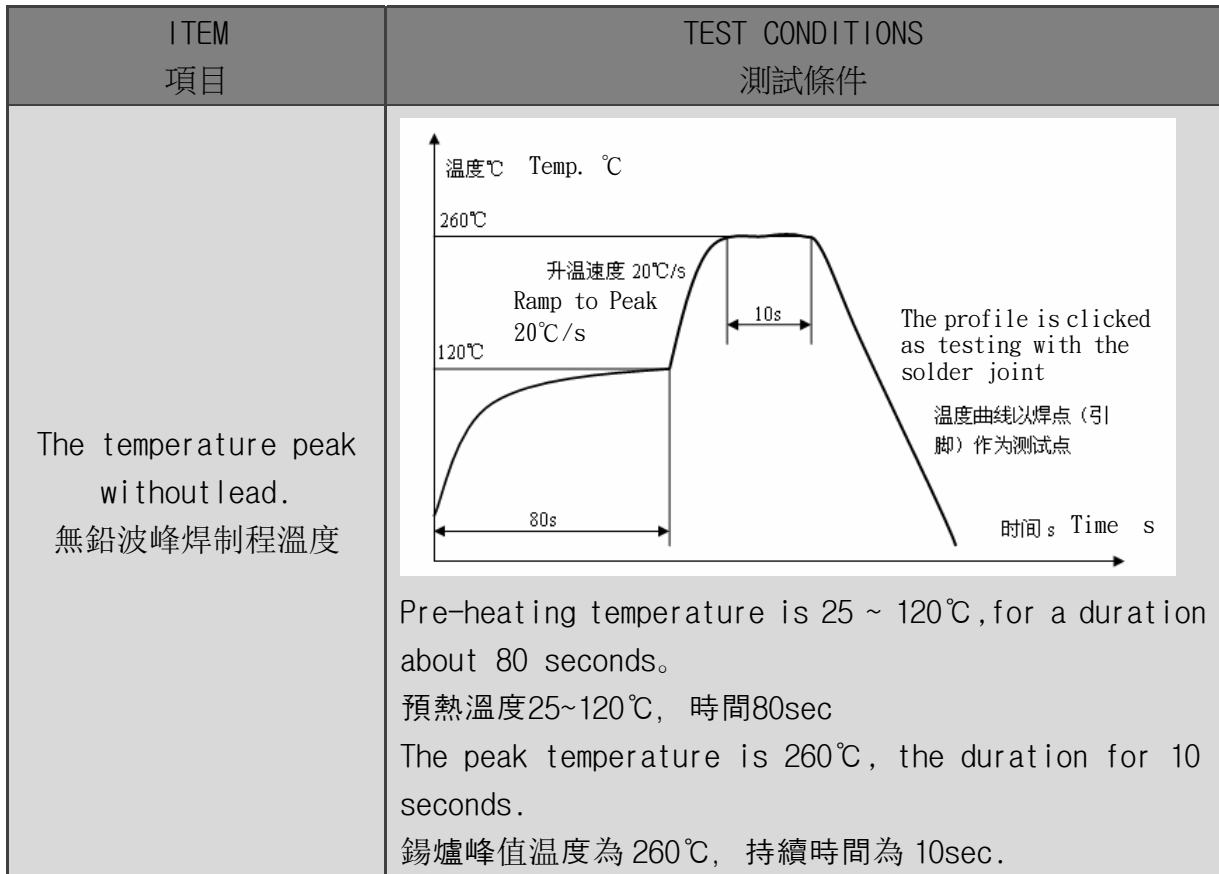

G) . MATED PLUG 適用插棒

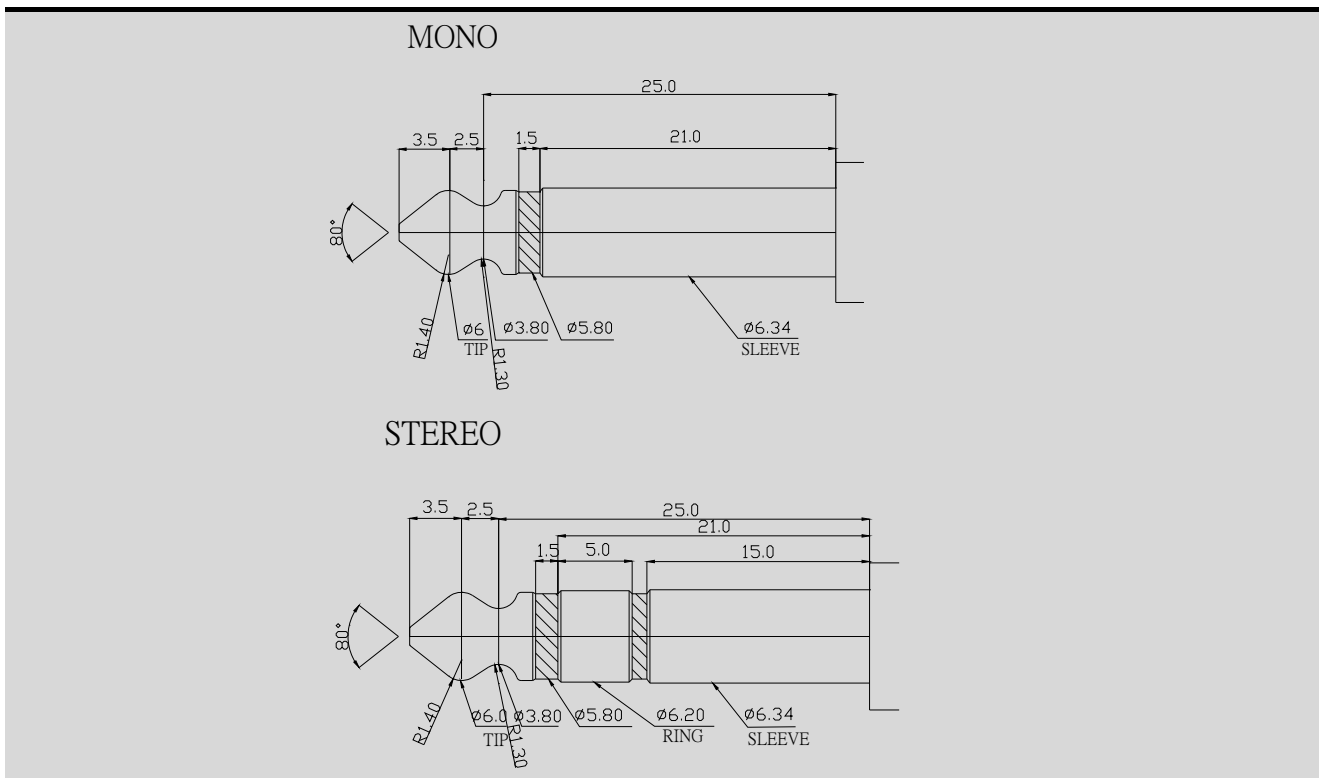

凱譽科技股份有限公司

KAI YUI TECHNOLOGIC CORP.

H) . MATED PLUG 適用插棒

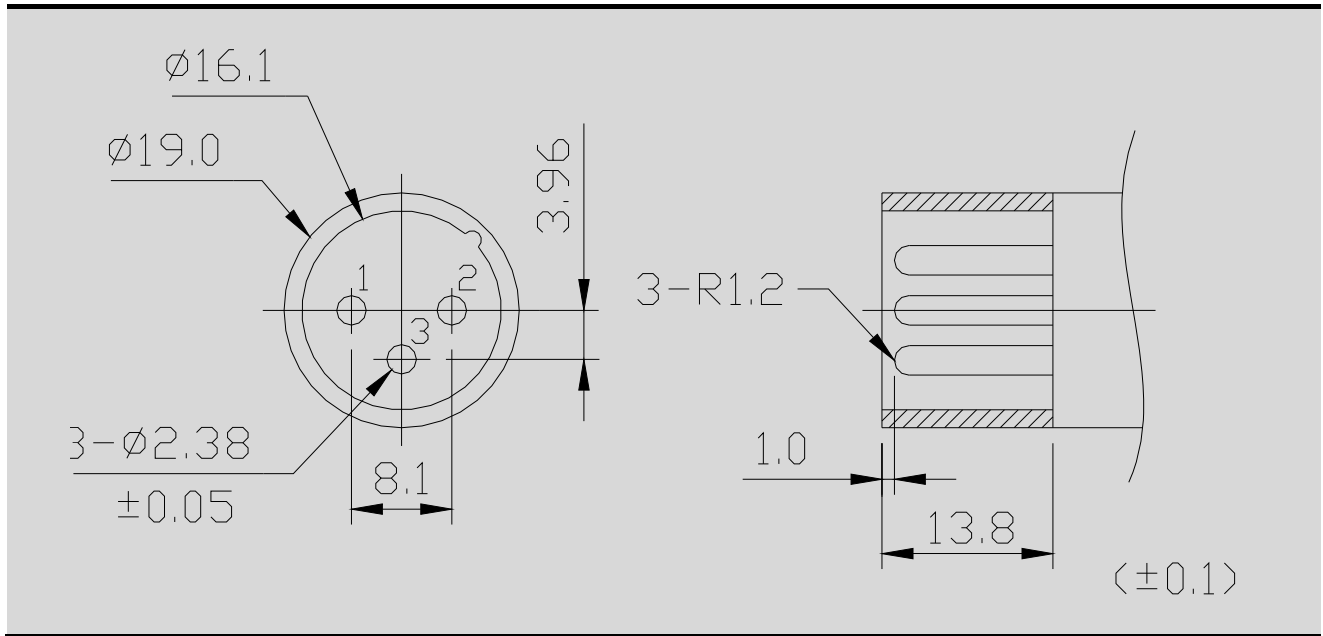

制定日期	A	C	M
2013. 04. 26	P	H	A
	V	K	K
	D	D	E
	Jacky	Dragon	Roy